



AMERICAN SPECIALTIES, INC.

MODEL No: 8215

ISSUED: 1-87

REVISED: 9-04

MOP AND BROOM HOLDER RACK

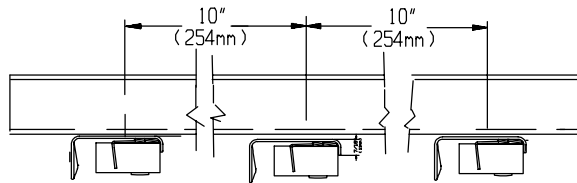
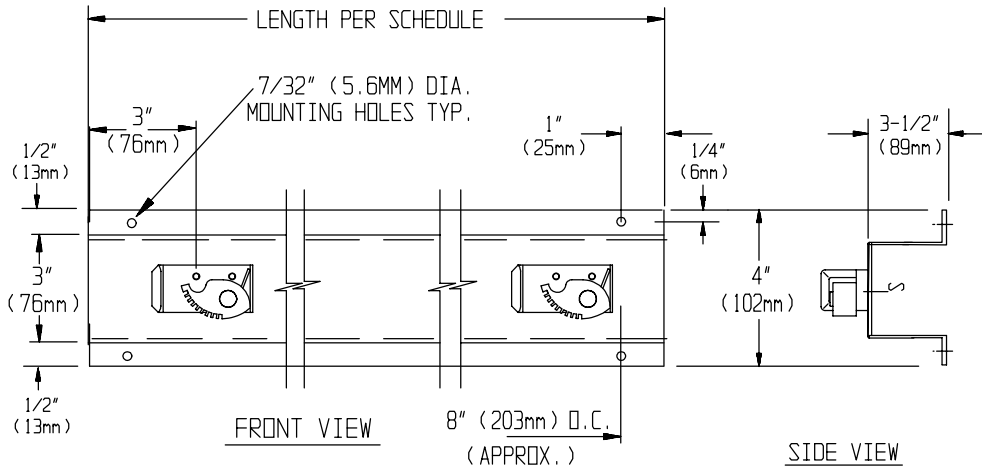

TOP VIEW LENGTH

MOP HOLDER QUANTITY

SCHEDULE OF AVAILABILITY		
ASI MODEL N°		
8215-3	26" (660mm)	3
8215-4	36" (914mm)	4
8215-5	46" (1168mm)	5

SPECIFICATION

Mop and Broom Holder Rack shall be fabricated of one-piece hi-hat channel alloy 18-8 stainless steel, type 304, 20 gauge (.9mm) with N° 4 satin finish. Horizontal edges of hi-hat shall return 3-1/2" (89mm) to wall. Mop holder brackets shall be fabricated of cadmium-plated steel and shall be ribbed for rigidity. Each mop holder shall have a pivoting spring loaded serrated rubber cam that shall hold round handles of 7/8" to 1-1/4" (22mm to 32mm) dia. wedged against ribbed clamp plate.

INSTALLATION

For general utility mount rack 70" (1778mm) above finished floor (AFF) from bottom of rack with N° 10 self-tapping screws (by others) through holes provided. For compliance with ADA Accessibility Guidelines, install unit so that top of rack is 54" (1372mm) maximum AFF if clear floor side reach access is provided or 48" (1219mm) maximum AFF if clear floor forward reach access is provided.

OPERATION

Mop or broom handle is pushed into grip-jaw of pivoting serrated rubber cam with upward motion until it seats behind rib on clamp plate. Spring holds cam against handle. Gravity holds mop clamped in position.